



J6

Quick Reference Guide (English)

First Time with J6

Equipment required:

- Bean (Bean container)
- Water (Water Tank)
- Milk tube (connecting machine & milk container)

These short instructions do not replace the »J6 Instructions for Use«. Make sure you read and observe the safety information and warnings first in order to avoid hazards.

»Display«

Water Hardness

1

tauchen leicht ab- und nachlesen.
Dip briefly (1 sec.) shake off excess water and compare after 1 min.
Plongez brièvement (1 sec.) agouitez l'excès d'eau et comparez après 1 min.

| | | | | |
|-----------|-----|--------|---------|---------|
| reenviert | 0-1 | <3°dH | <3,75°w | <5,4°f |
| rouge | 2 | >3°dH | >3,75°w | >5,4°f |
| rouge | 3 | >4°dH | >4,5°w | >6,3°f |
| rouge | 4 | >5°dH | >5,6°w | >7,2°f |
| rouge | 5 | >6°dH | >6,8°w | >8,4°f |
| rouge | 6 | >7°dH | >7,9°w | >9,6°f |
| rouge | 7 | >8°dH | >9,0°w | >10,8°f |
| rouge | 8 | >9°dH | >10,1°w | >12,0°f |
| rouge | 9 | >10°dH | >11,2°w | >13,2°f |
| rouge | 10 | >11°dH | >12,3°w | >14,4°f |
| rouge | 11 | >12°dH | >13,4°w | >15,6°f |
| rouge | 12 | >13°dH | >14,5°w | >16,8°f |
| rouge | 13 | >14°dH | >15,6°w | >18,0°f |
| rouge | 14 | >15°dH | >16,7°w | >19,2°f |
| rouge | 15 | >16°dH | >17,8°w | >20,4°f |
| rouge | 16 | >17°dH | >18,9°w | >21,6°f |
| rouge | 17 | >18°dH | >20,0°w | >22,8°f |
| rouge | 18 | >19°dH | >21,1°w | >24,0°f |
| rouge | 19 | >20°dH | >22,2°w | >25,2°f |

Filter Cartridge Activation

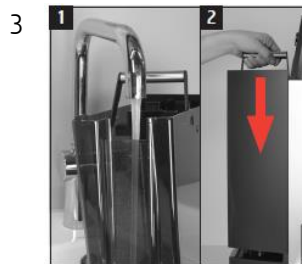

- »Filter operation/Saved«
- »Filter is being rinsed«
- » System is filling«
- »Empty drip tray«

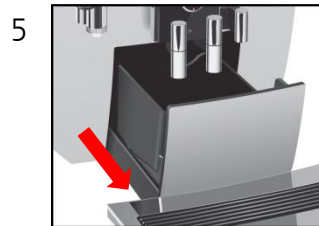

- »Machine is heating«
- »Machine is rinsing «



Connecting milk

Remove the protective cover

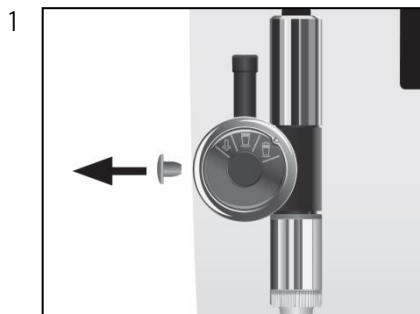

Attach the milk pipe

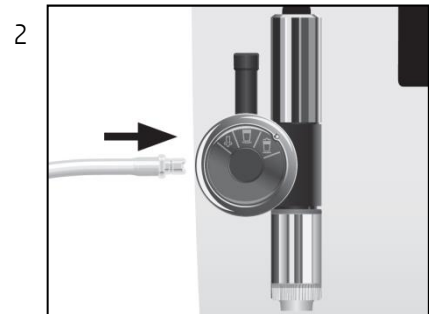

How to make coffee

Equipment required:

- Bean (Bean container)
- Water (Water Tank)
- Milk tube (connecting machine & milk container)

These short instructions do not replace the »J6 Instructions for Use«. Make sure you read and observe the safety information and warnings first in order to avoid hazards.

»Display«

Place Cup under the coffee spout

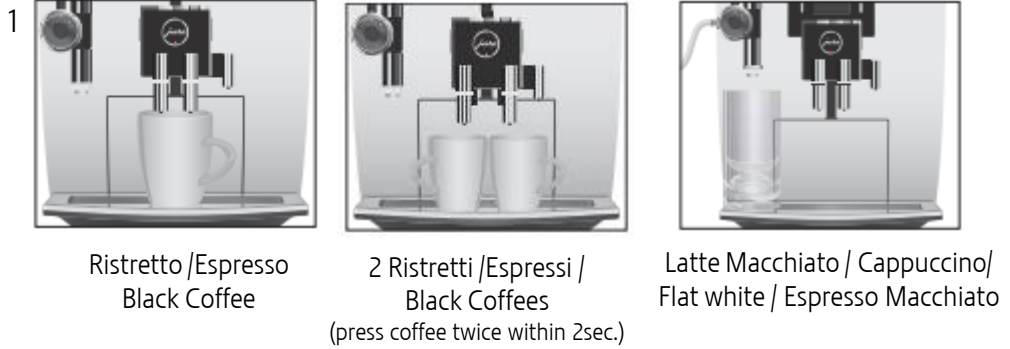

Select Coffee by pressing Rotary Switch / Start Menu



Permanent Personalize Coffee Setting



Press P Button » Product Setting - Expert Mode«

» Enough Coffee? « - Adjust volume by Rotary Switch

» Coffee Strength « - Adjust coffee grind amount by Rotary Switch



Alternative:

1. Hold Drink Button for 2-3 sec in start menu
2. » Enough Coffee? «
3. » Save«

Cleaning the milk system

Approximate duration 2 min.

Equipment required:
JURA Milk system cleaner



These short instructions do not replace the »J6 Instructions for Use«. Make sure you read and observe the safety information and warnings first in order to avoid hazards.

»Display«

Precondition:

»Clean the milk system «
Press "P" Button or Rotary Switch



»Maintenance status«
»Clean the milk system «



»Cleaning agent for milk system & Water«

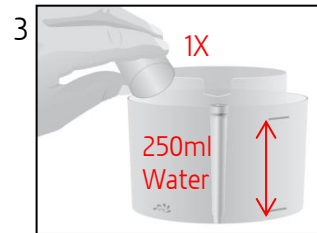

Connect the milk tube

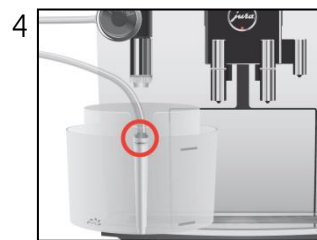

Milk position

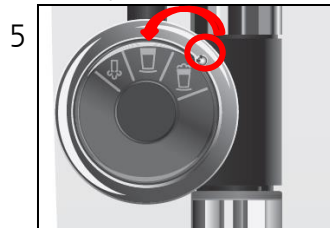

» Press Rotary Switch«
»Next «



»Milk system is being cleaned«
»Milk Foam «

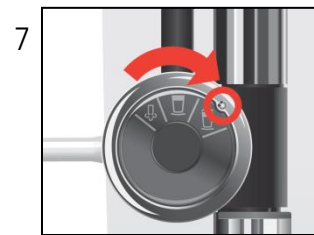

»Water for cleaning milk system«

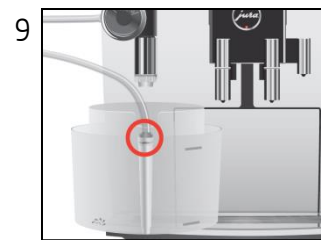
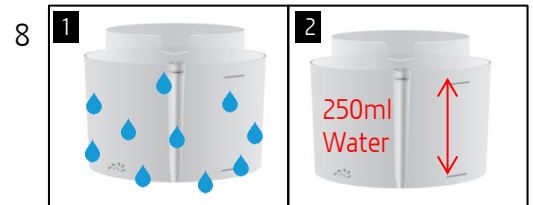

»Milk system is being cleaned«

Dismantling and rinsing The fine frother (Deep Cleaning)

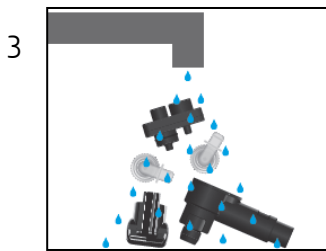
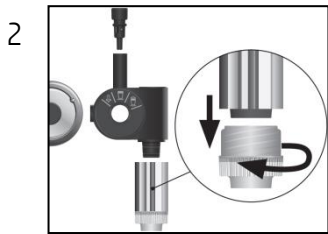
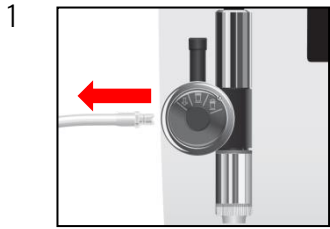

With severely dried-on milk residues



J6

Changing the filter

Approximate duration 3-5min.

Equipment required:
JURA Filter cartridge CLARIS
Smart



These short instructions do not replace the »J6 Instructions for Use«. Make sure you read and observe the safety information and warnings first in order to avoid hazards.

»Display«



Precondition:

»Change filter«

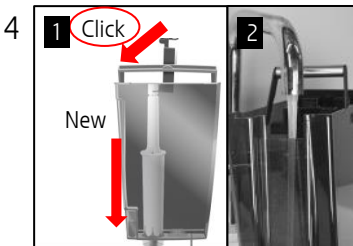
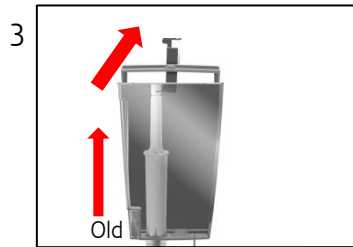

»Saved«
»Filter is being rinsed«
»Empty drip tray«

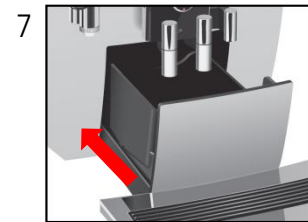
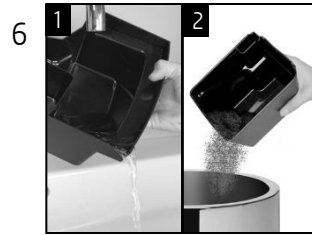
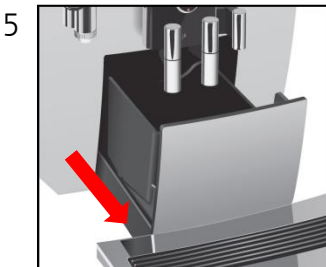

»Filter rinsing completed«

Descaling the machine

Approximate duration 45 min.

Equipment required:
JURA 2-phase descaling tablets



These short instructions do not replace the »J6 Instructions for Use«. Make sure you read and observe the safety information and warnings first in order to avoid hazards.

»Display«

*Completely dissolve in several min.

Precondition:
»Decalcify machine«
Press P button or Rotary Switch

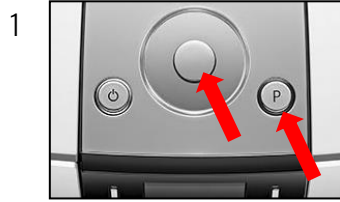

» Maintenance status«
» Descal«



»Empty drip tray«

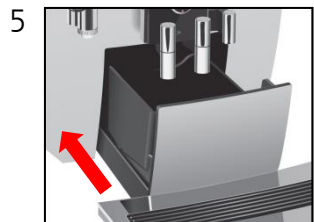
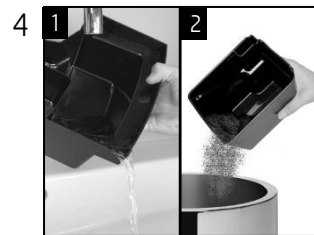
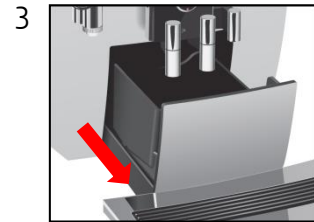

»Pour descaling agent* into empty water tank«

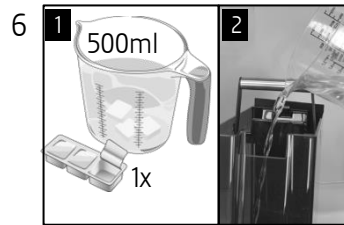

»Press Rotary Switch«
»Machine is being descaled«
»Empty drip tray«

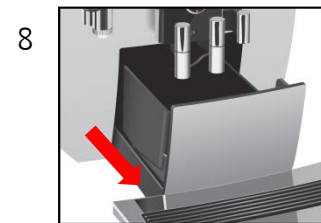

Repeat Step 4-5
»Fill water tank«

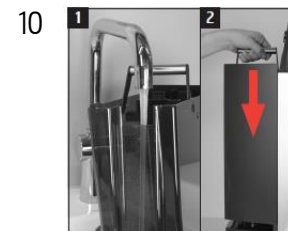
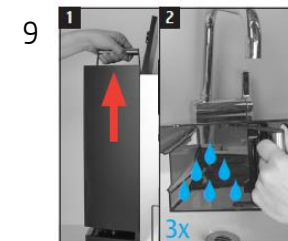

» Press Rotary Switch«



»Press Rotary Switch«
»Machine is being descaled«
»Empty drip tray«

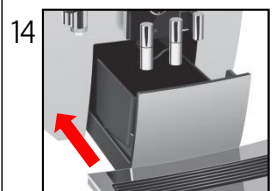
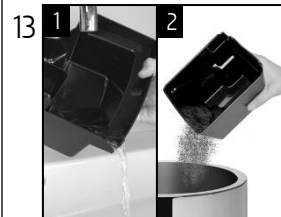
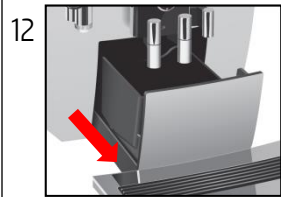

Cleaning the machine

Approximate duration 20 min.

Equipment required:
JURA 2-phase-cleaning tablets



These short instructions do not replace the »J6 Instructions for Use«. Make sure you read and observe the safety information and warnings first in order to avoid hazards.

»Display«

Precondition:

»Clean machine«
Press "P" Button &
Rotary Switch



»Maintenance status«
»Clean the machine«



»Clean«
»Empty coffee grounds
container«

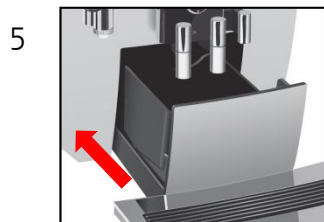
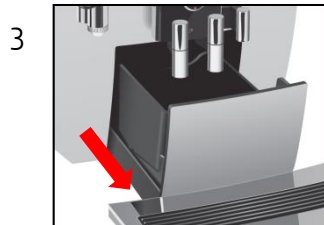

» Press Rotary Switch«



»Machine is being cleaned«
»Add cleaning tablet«



»Machine is being cleaned«
»Empty coffee grounds
container«
Repeat Step 3-4

